

SPECIFICATION

| | | |
|-------------|---|------------------------------------------------------------------------------------------------------------------------------------------------------------------------------------------------------------------------------------------------------------------------------------------------------------------------------------|
| Part No. | : | OMB.8912. 05F21 |
| Description | : | Barracuda - 5 dBi Penta-band Cellular Indoor/Outdoor Omni-Directional Antenna |
| Feature | : | GSM850/ GSM900/ DCS/ PCS/ WCDMA I 850/ 900/ 1800/ 1900/ 2100 MHz Omni-Directional Radiation Pattern Collinear 5.56 dBi Peak Gain Robust Design for all Weather operation IP65 Waterproof Length: 595mm, Weight: 350g Connector: N-type Female Wall/Pole Mount Bracket Included RoHS compliant |



1. Introduction

The Penta-band cellular Barracuda Outdoor antenna is designed to have long distance coverage. Omni-directional high gain across all bands ensures constant reception and transmission. The UV resistant coating with fiberglass housing makes this antenna suitable to be mounted in robust outdoor environment, pole-mounting and wall-mounting bracket is included.

The antenna finds its usage in boosting cellular coverage in remote areas or difficult environments indoors and outdoors.

2. Specification

| ELECTRICAL | | | | | |
|-----------------------|-----------------------|---------|-----------|-----------|-----------|
| Standard | GSM | GSM | DCS | PCS | WCDMA I |
| Band | 850 | 900 | 1800 | 1900 | 2100 |
| Frequency (MHz) | 824~894 | 880~960 | 1710~1880 | 1850~1990 | 1920~2170 |
| Peak Gain (dBi) | 3.04 | 3.03 | 4.30 | 4.83 | 5.56 |
| Average Gain (dBi) | 2.52 | 2.76 | 3.50 | 4.57 | 4.63 |
| Efficiency (%) | 84.2 | 88.7 | 77.8 | 84.5 | 84.2 |
| Antenna Type | Collinear | | | | |
| Polarization | Vertical | | | | |
| Impedance | 50 ohms | | | | |
| Max Input Power | 50 watts | | | | |
| VSWR | <2.0:1 | | | | |
| Radiation | Omni-Directional | | | | |
| Vertical Bandwidth | 30 Deg | | | | |
| Horizontal Bandwidth | 360 Deg | | | | |
| Antenna Design | Dipole Array | | | | |
| Internal Material | Copper | | | | |
| Connector | N Type Female | | | | |
| MECHANICAL | | | | | |
| Length | 595 mm | | | | |
| Bracket Dimension | 70*35mm(Max) | | | | |
| Radome Diameter | 24mm | | | | |
| Antenna Weight | 350g | | | | |
| Mounting Accessories | 70g | | | | |
| Application | Indoor/Outdoor | | | | |
| Radome Material | White Fiberglass | | | | |
| Mount Style | Pole Mount/Wall Mount | | | | |
| Mounting | Stainless Steel | | | | |
| Wind Resistance | >150mph (>241km/h) | | | | |
| Waterproof | IP65 | | | | |
| ENVIRONMENTAL | | | | | |
| Storage Temperature | -40°C to +80°C | | | | |
| Operating Temperature | -40°C to +60°C | | | | |

| | |
|--------------------|------------------------|
| Operating Humidity | 10%~80% non-condensing |
| Storage Humidity | 5%~80% non-condensing |

3. Antenna Characteristics

3.1 Return Loss

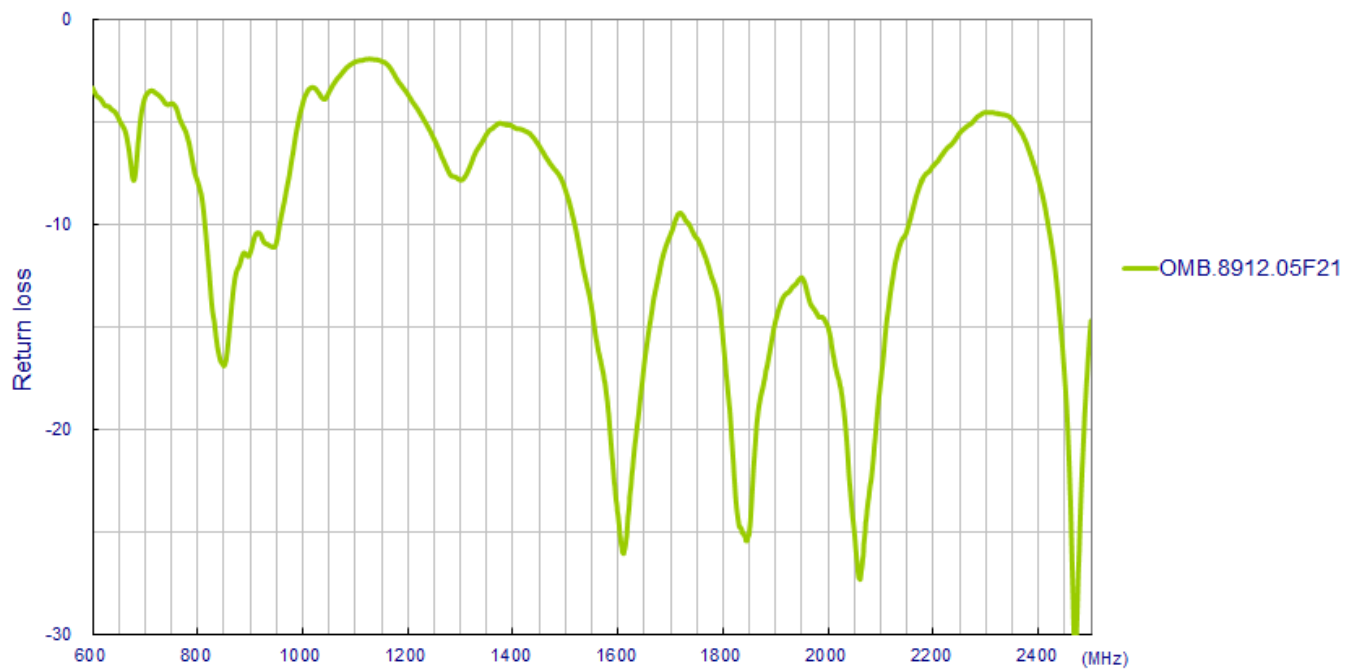

3.2 Maximum Gain

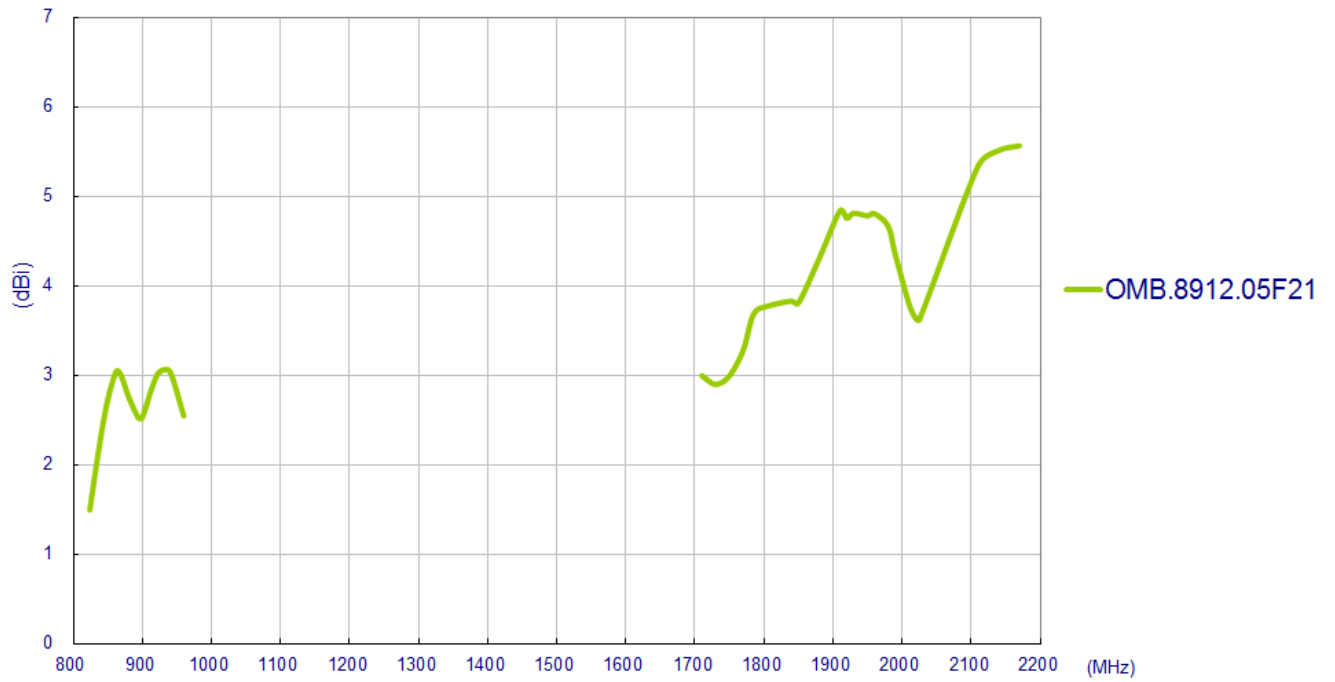

3.3 Efficiency

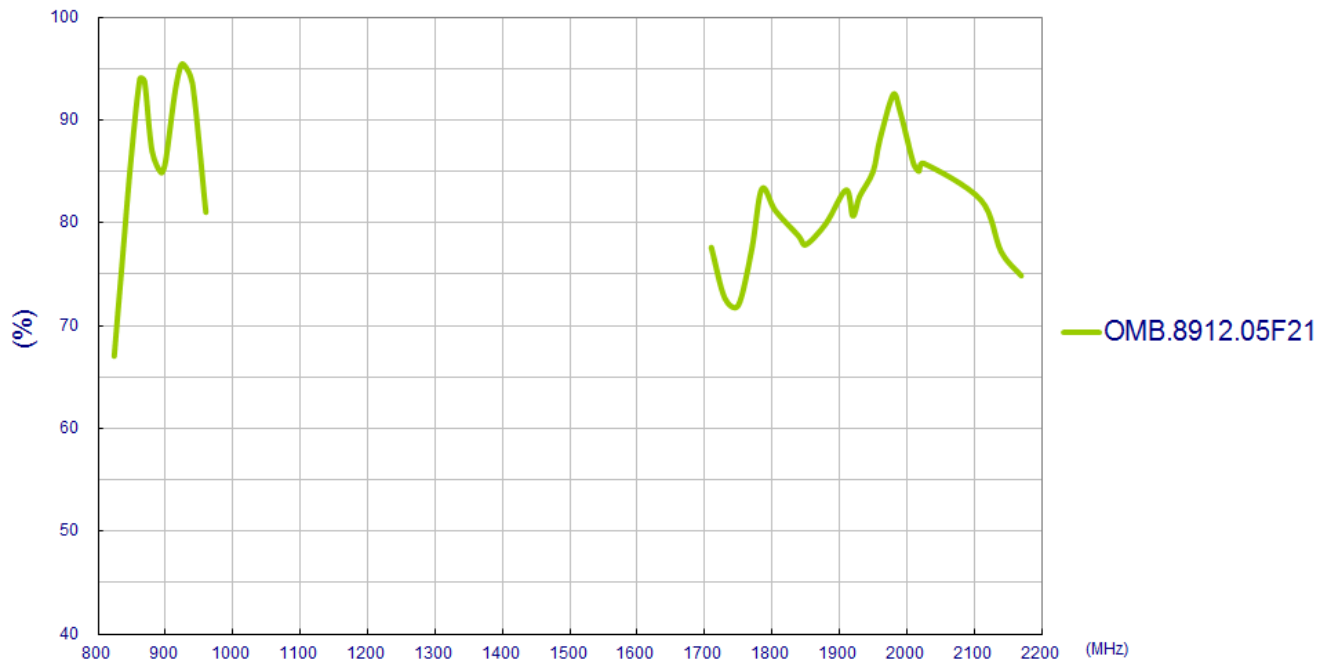

4.3D Radiation Property



Horizontal XY-plane

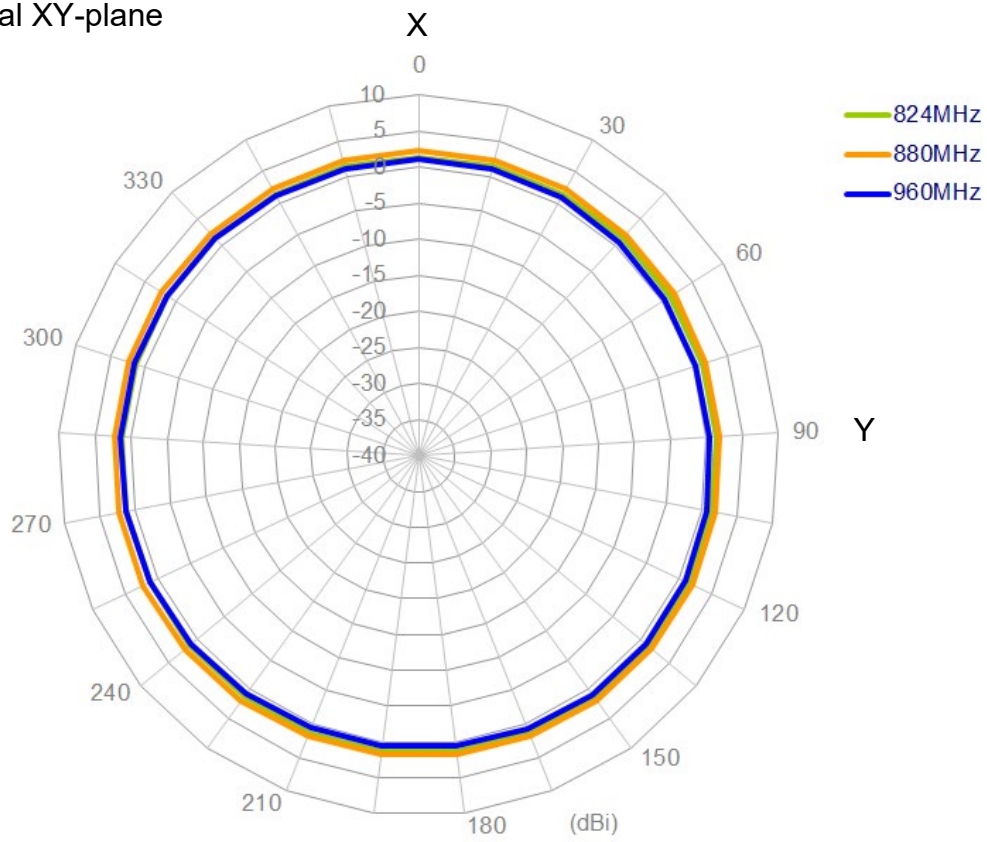

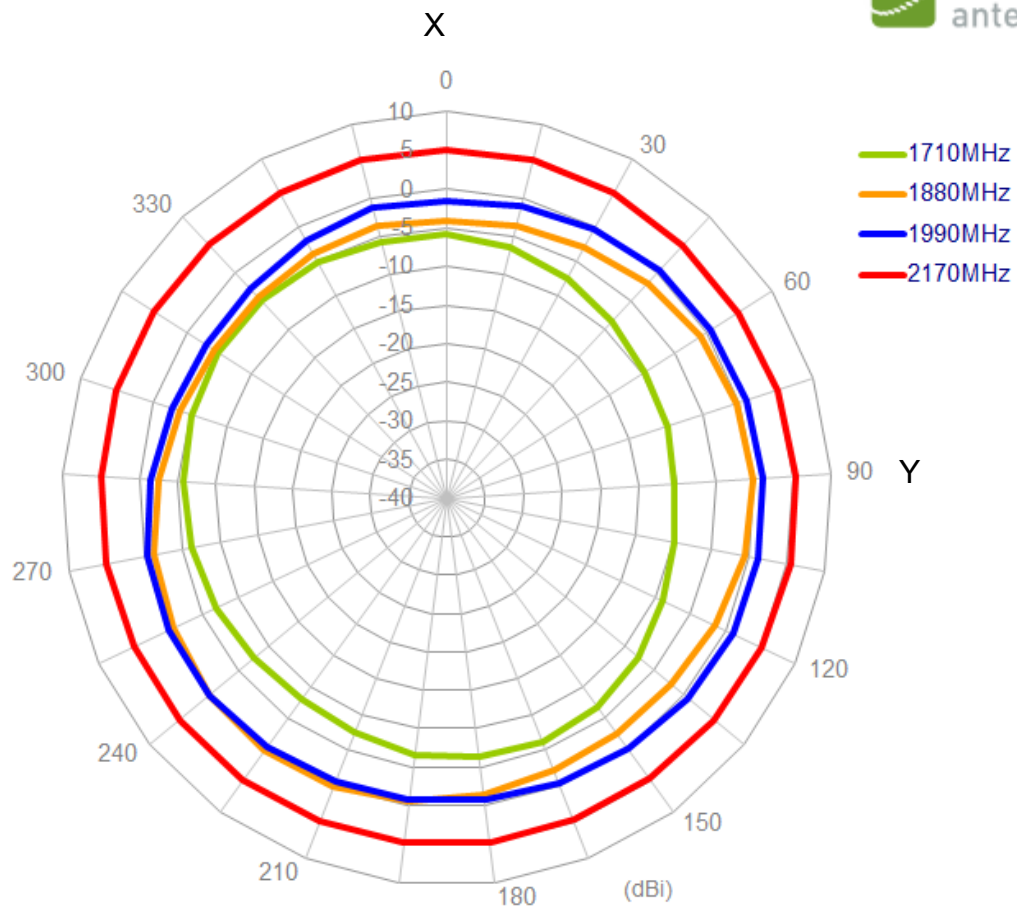

Vertical XZ-plane

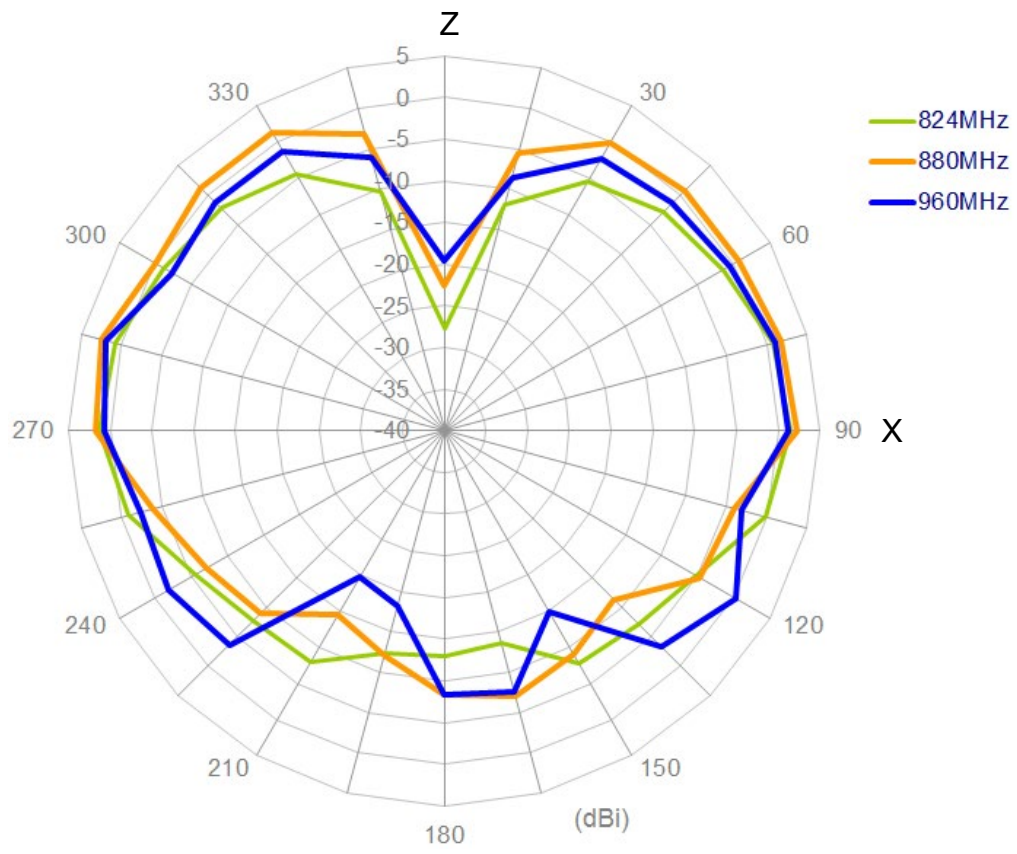

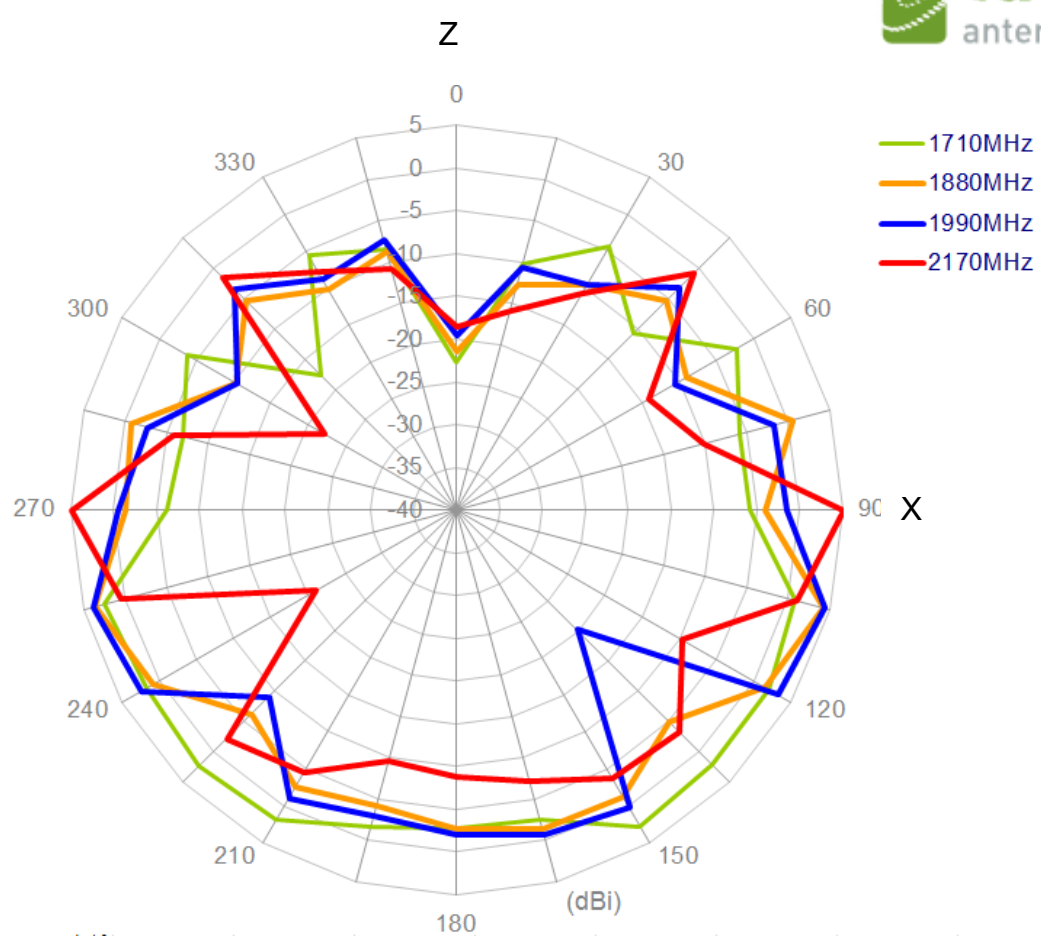

5. Drawing

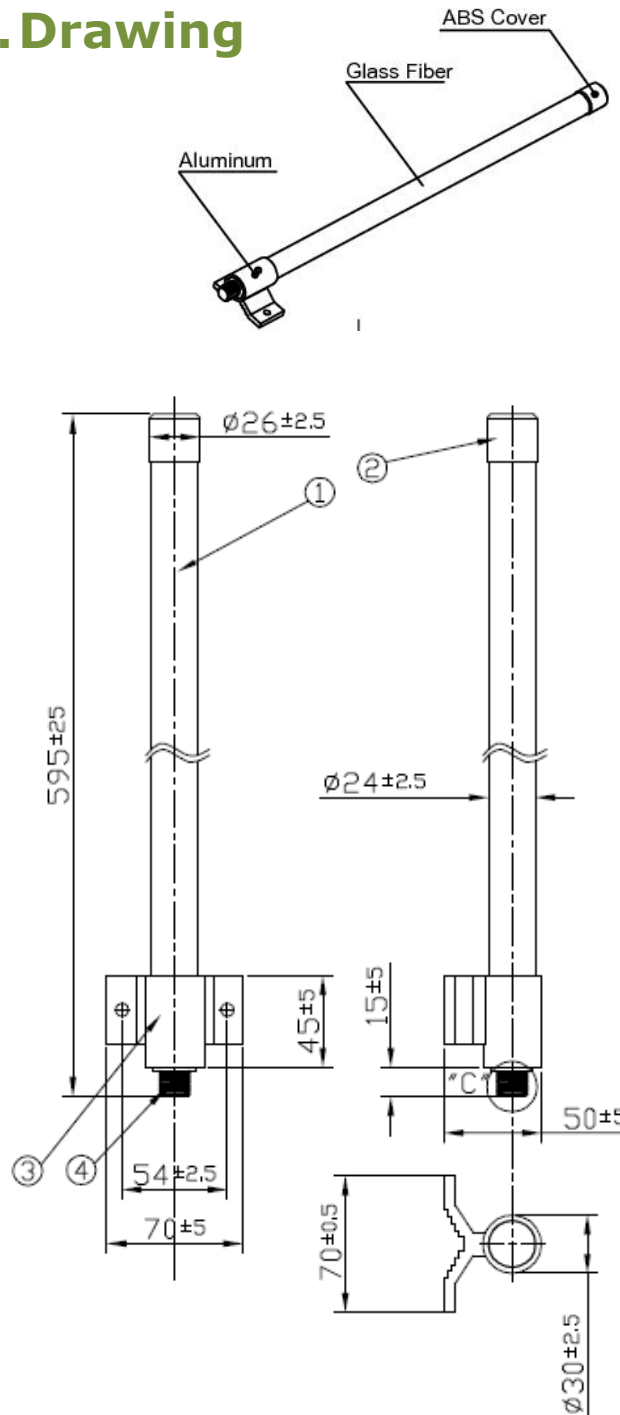

Bracket

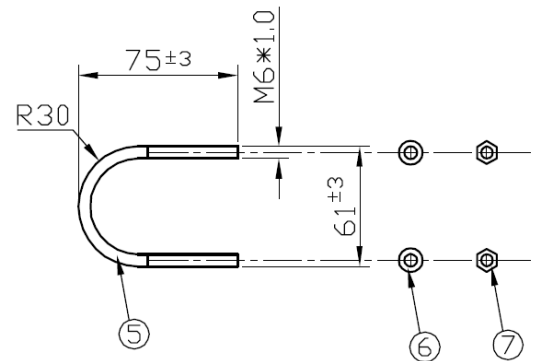

N Type (F)

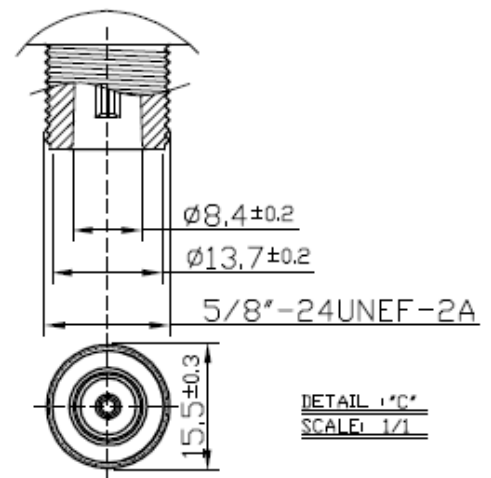

DETAIL 1:1
SCALE: 1/1

| | Name | P/N | Material | Finish | QTY |
|---|------------------|----------------|-----------------|-----------|-----|
| 1 | OMB.8912 Antenna | 001212C010021A | Glass Fiber | White | 1 |
| 2 | Cover | 000111K000021A | ABS | Silver | 1 |
| 3 | Holder | 000311K000021A | Aluminum | Silver | 1 |
| 4 | N Type(F) | 201211K000021A | Brass | Ni Plated | 1 |
| 5 | M6 U Type Screw | 000411K000021A | Stainless Steel | Silver | 1 |
| 6 | M6 Washer | 000411K010021A | Stainless Steel | Silver | 1 |
| 7 | M6 Nut | 000411K020021A | Stainless Steel | Silver | 1 |

6. Packaging

1 OMB.8912.05F21 per tube
 Tube Dimensions - Ø80mm*Height 805mm
 Total Weight - 634.5g

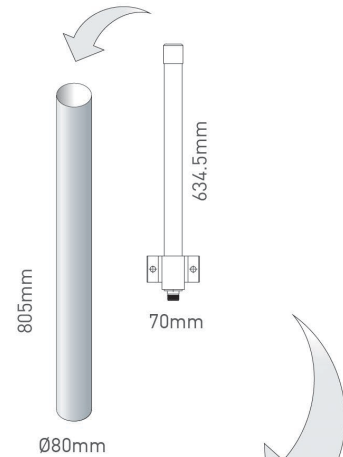

10 tubes per carton
 10 pcs OMB.8912.05F21 per carton
 Carton Dimensions - 815*410*185mm
 Weight - 7.49kg

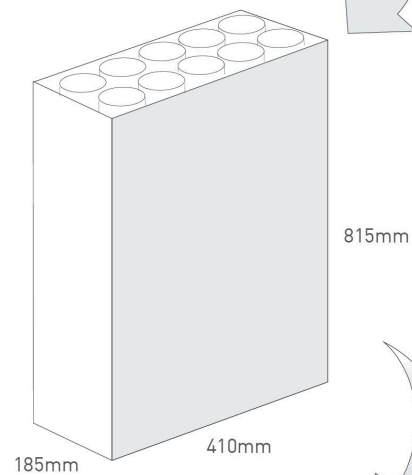

Pallet Dimensions 1200mm*1000mm*1495mm
 14 Cartons per Pallet
 2 Cartons per layer
 7 Layers

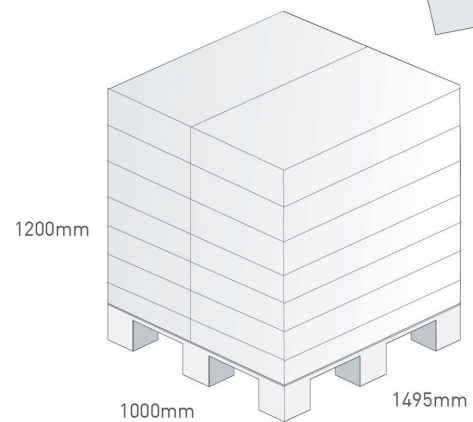

7. Antenna Installation Guide

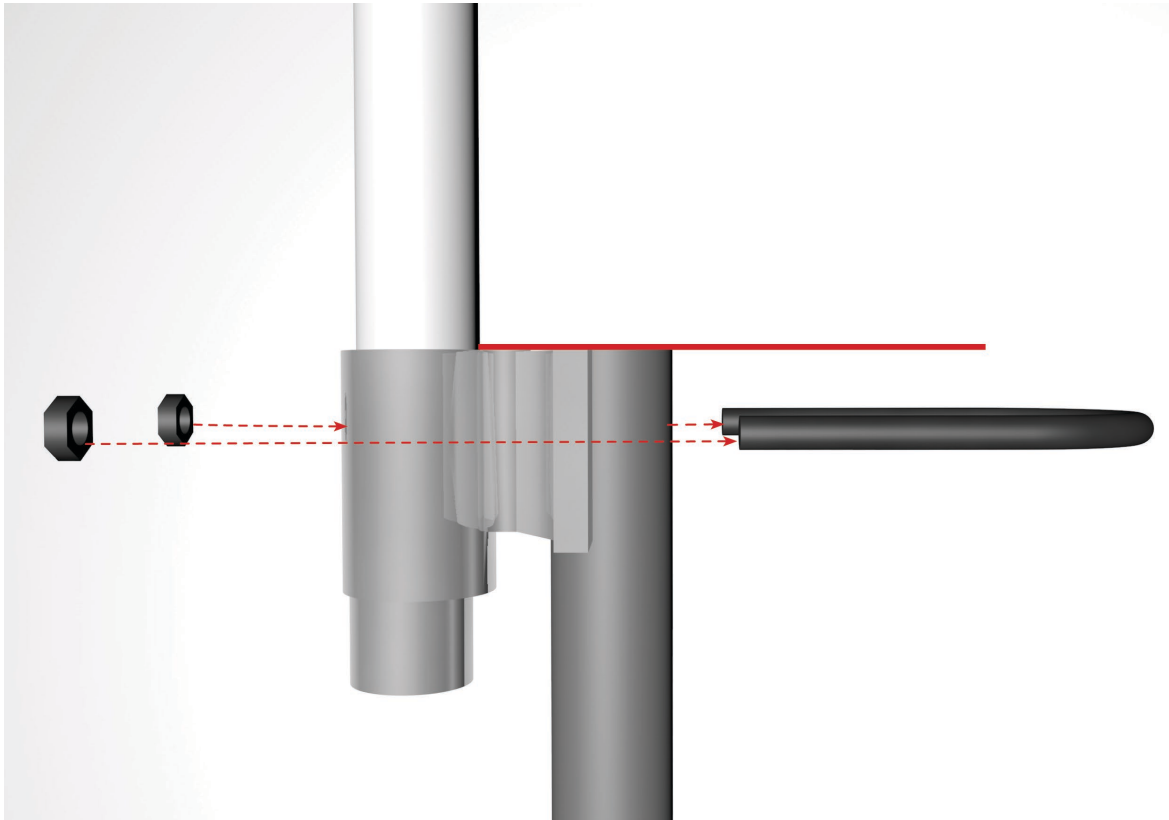

Taoglas makes no warranties based on the accuracy or completeness of the contents of this document and reserves the right to make changes to specifications and product descriptions at any time without notice. Taoglas reserves all rights to this document and the information contained herein.

Reproduction, use or disclosure to third parties without express permission is strictly prohibited.

Copyright © Taoglas Ltd.