

## **High Power Dual Directional Coupler Datasheet**

### **WMHPDDC30-2040-NMFS**

#### **Features**

- 400 watts average power handling.
- DC Passing from Input to Output.
- Air dielectric.
- Dual directional.
- 1 year warranty.
- Made in USA.

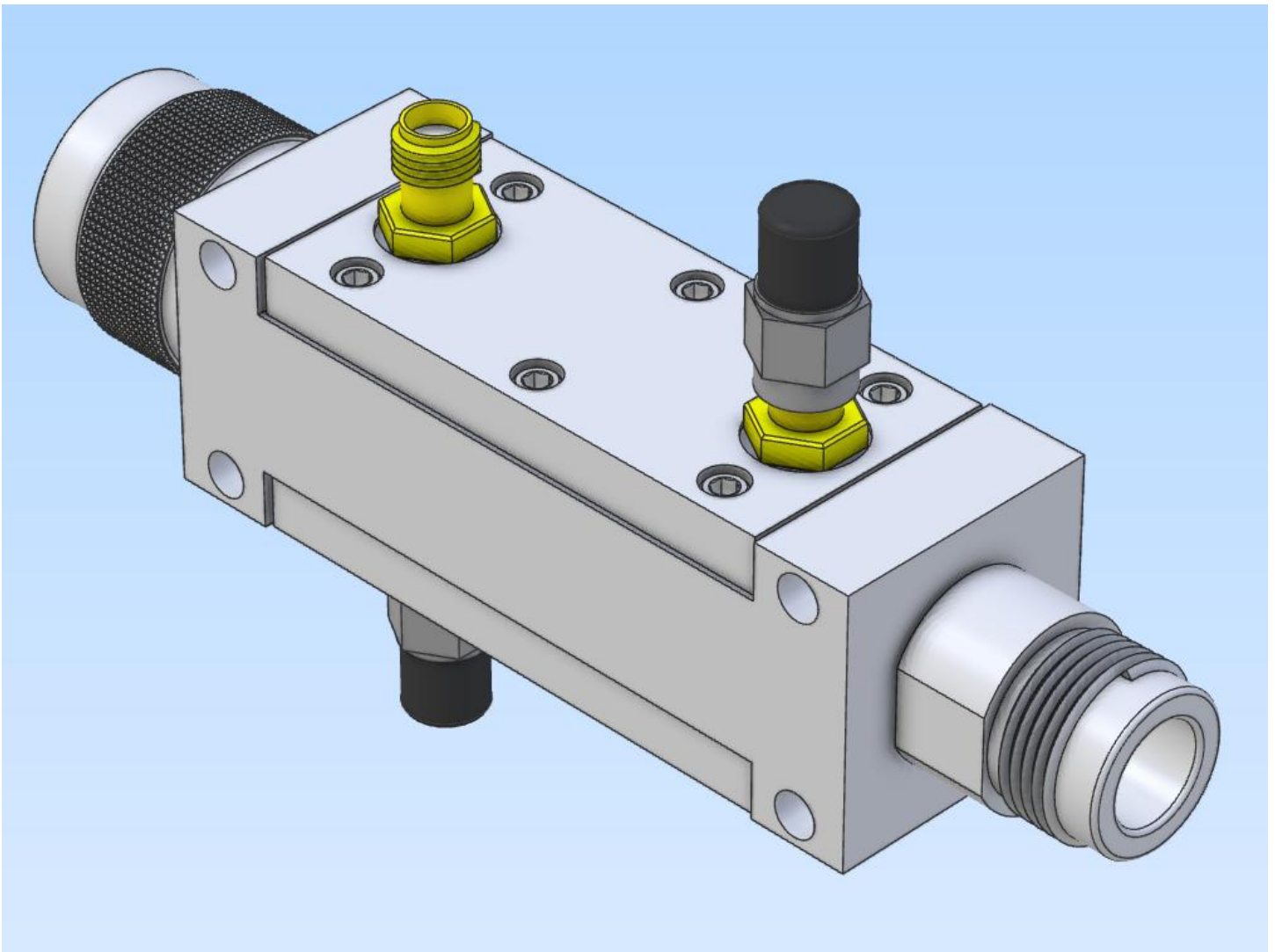

Product in current development. 3D rendering is presented. Some features omitted for clarity.

## Outline Drawing

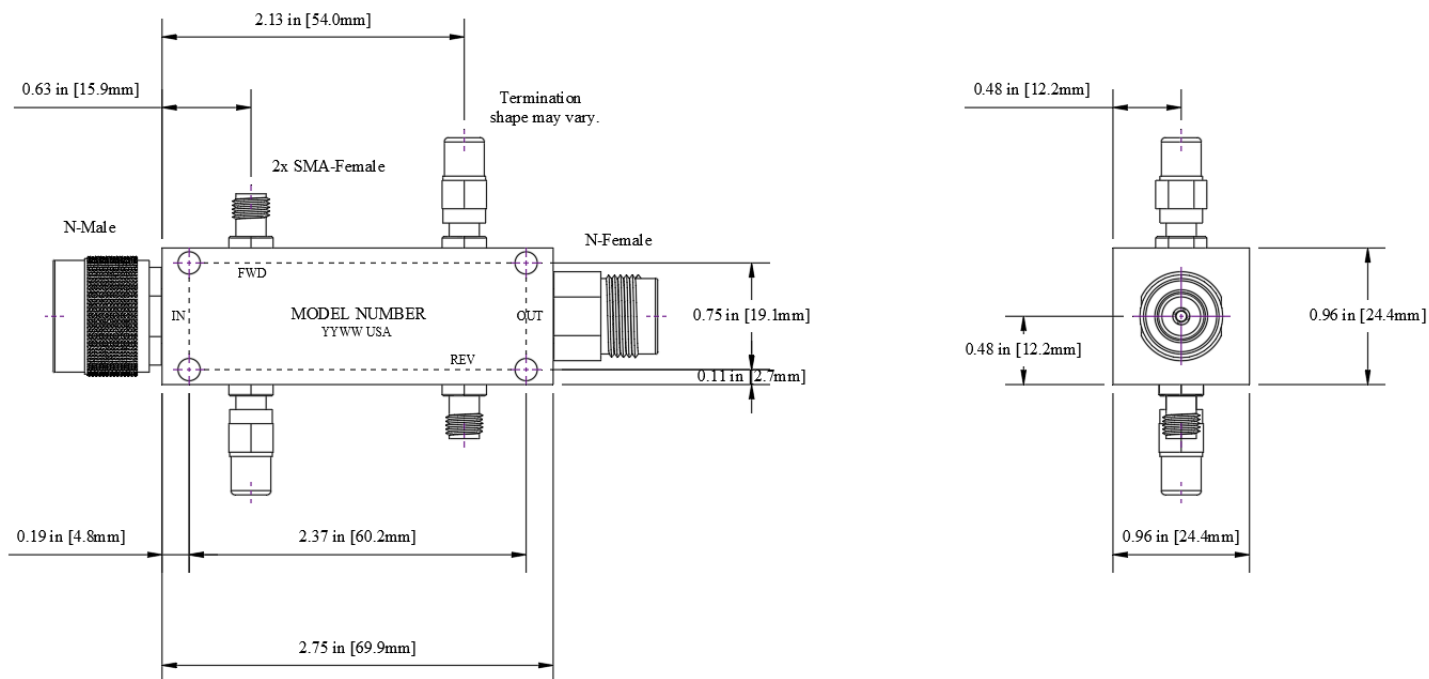

Outline drawing # OL-AIRCPL-2060-2 (Werbel reference).

Dimensions are in inches, [mm] shown for convenience.

Tolerances on 2-pl decimals:  $\pm 0.03$ . 3-pl decimals:  $\pm 0.015$ .

## Simplified Electrical Schematic

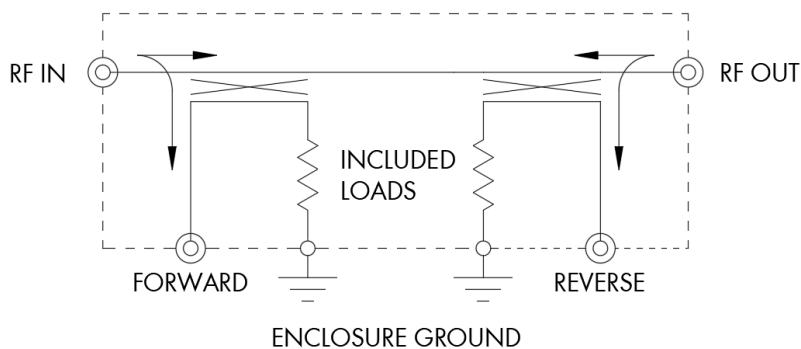

Electrical Specifications (at +25 °C)	Min	Typ.	Max	Units
Frequency Range	2000		4000	MHz
Impedance		50		Ohm
Coupling	28.25	30	31.75	dB
Mainline Loss <sup>1</sup>			0.3	dB
Directivity	20			dB
Mainline Return Loss (In and Out)	20			dB
Secondary Line Return Loss	20			dB
Isolation		50		dB
Forward Power (Average) <sup>2</sup>			400	W
Reverse Power (Average) <sup>2</sup>			400	W
Termination Power			1	W
DC Current (In to Out)			10	A

Mechanical	Specification
Environment	Indoor Use
Humidity	10 - 90% non-condensing
Operating Temperature <sup>3</sup>	-55 to +85 °C
Storage Temperature	-55 to +100 °C
Finish	Clear Chemical Conversion Film (Conductive)
In/Out Connectors	N Male/Female, Stainless Steel
Coupled Connector	SMA Female, Brass, Gold Plated
Estimated Weight	230 g (8.1 oz)

Regulatory	Specification
RoHS Compliant <sup>4</sup>	Yes
REACH Compliance <sup>4</sup>	Unaffected
ECCN	EAR99
HTSUS	8525.50.3035
Country of Origin	United States of America

1. Mainline loss includes coupling loss.
2. All output ports should be terminated in a 50-ohm load with 1.2:1 max VSWR.
3. Electrical specifications are at +25 °C.
4. To the best of our knowledge at time of publication.

The information contained in this document is accurate to the best of our knowledge and representative of the part described herein. It may be necessary to make modifications to the part and/or documentation of the part, in order to implement improvements. Werbel Microwave LLC reserves the right to make such changes as required without notice. Unless otherwise stated, all specifications and dimensions are nominal. Werbel Microwave does not make any representation or warranty regarding the suitability of the part described herein for any particular purpose, and Werbel Microwave LLC does not assume any liability arising out of the use of any part of documentation. This document gives only a description of the product(s) and shall not form part of any contract. Please contact a Werbel Microwave LLC Applications Engineer for the most current specification drawing.