

The Bulldog PRO Series is an omni-directional antenna that is 4x4 MIMO cellular that can be configured to 8x8 MIMO cellular and have up to 4x4 MIMO Wi-Fi. The Bulldog is ideal for retail, office, and ceiling tile applications to provide high speed performance. The design of the Bulldog is inconspicuous and blends in with the ceiling of almost any room. Mounting the antenna on the ceiling eliminates the problem of interference from metal obstructions in a hardware closet.

Patent Pending



Configurations 4:1 | 8:1 | 12:1

Transportation & Fleet | Fixed Wireless Access | Mobile Broadband



### ***Always Be Connected with Dual 5G***

Dual SIM & Dual Radio in One Antenna

#### ***Easy Install***

Can Replace Ceiling Tile

#### ***Discreet Design***

Blends in with Most Ceilings

- Up to 8X8 MIMO CELLULAR
- UP TO 4X4 MIMO WI-FI
- OMNI-DIRECTIONAL
- 600-6000 MHz
- 23.7 inch X 23.7 inch X 2.2 inch
- WI-FI 6 COMPATIBLE

## Specifications

<i><b>Frequencies</b></i>			
4G/5G Cellular	617-698 MHz 698-894 MHz 1710-2700 MHz 3300-4000 MHz 5150-5925 MHz	Wi-Fi	2400-2483.5 MHz 4900-5900 MHz
<i><b>4G/5G Bands</b></i>			
North America	B2, B4, B5, B7, B12, B14, B17, B25, B26, B29, B30, B41, B46, B48, B66, B71 n2, n5, 12, n25, n26, n41, n48, n66, n71, n77		
EMEA	B1, B3, B7, B20, B28, B42, B43, B46 n1, n3, n28, n77, n78		
<i><b>Mechanical</b></i>		<i><b>Environmental</b></i>	
Dimension	23.7 inch X 23.7 inch X 2.2 inch	Operating Temperature	-30 °C to 85°C OR -22 °F to 180°F
Mounting	Fits suspended ceilings	Ingress Protection	Indoor use only
RF Cable Length	Choice of 2 or 15 ft Cable		

## Dimensions

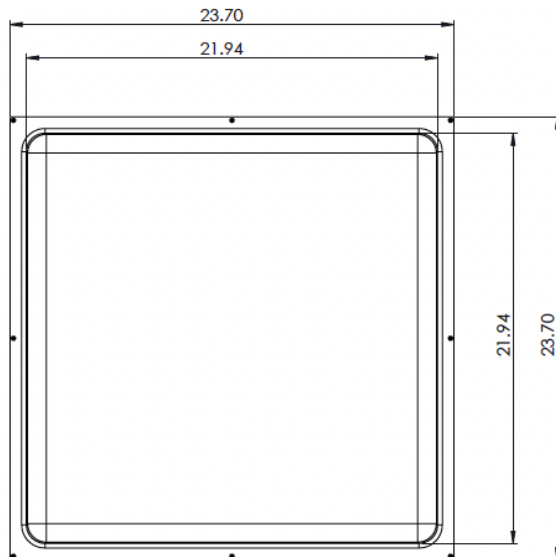

## Product Images



## Electrical Specifications

<i>ID &amp; Unit</i>	<i>Port</i>	<i>Parameters</i>	<i>Typ.</i>
<b>Radiated Efficiency (%)</b>	CELL 1 thru 8	617-698 MHz	75
	CELL 1 thru 8	698-894 MHz	85
	CELL 1 thru 8	1710-2700 MHz	85
	CELL 1 thru 8	3300-4000 MHz	75
	CELL 1 thru 8	5150-5925 MHz	60
	Wi-Fi 1 thru 4	2400-2483.5 MHz	80
	Wi-Fi 1 thru 4	4900-5900 MHz	70
<b>Peak Gain (dBi)</b>	CELL 1 thru 8	617-698 MHz	2
	CELL 1 thru 8	698-894 MHz	5
	CELL 1 thru 8	1710-2700 MHz	7
	CELL 1 thru 8	3300-4000 MHz	8
	CELL 1 thru 8	5150-5925 MHz	6
	Wi-Fi 1 thru 4	2400-2483.5 MHz	5
	Wi-Fi 1 thru 4	4900-5900 MHz	7
<b>Return Loss 50Ω (dB)</b>	CELL 1 thru 8	617-698 MHz	7.5
	CELL 1 thru 8	698-894 MHz	11
	CELL 1 thru 8	1710-2700 MHz	11
	CELL 1 thru 8	3300-4000 MHz	9.5
	CELL 1 thru 8	5150-5925 MHz	6.5
	Wi-Fi 1 thru 4	2400-2483.5 MHz	15
	Wi-Fi 1 thru 4	4900-5900 MHz	9

Isolation (dB)	CELL 1 thru 8	617-698 MHz	13
	CELL 1 thru 8	698-894 MHz	13
	CELL 1 thru 8	1710-2700 MHz	20
	CELL 1 thru 8	3300-4000 MHz	25
	CELL 1 thru 8	5150-5925 MHz	30
	Wi-Fi 1 thru 4	2400-2483.5 MHz	30
	Wi-Fi 1 thru 4	4900-5900 MHz	35
Polarization (dBi)	CELL, Wi-Fi		Linear
Max Input Power (Watts)	CELL, Wi-Fi		60
RF Connectors	CELL Wi-Fi		SMA(M) RPSMA(M)
RF Cable Type	CELL, Wi-Fi		LSR200
<ul style="list-style-type: none"> <li>Electrical specifications based on antenna with a 2 ft x 2 ft external ground plane.</li> <li>Isolation, return loss, and peak gain does not include cable loss.</li> <li>SMA connectors have a max torque of 3-5 inch lbs.</li> <li>NF connectors have a max torque of 6.2-9.7 inch lbs.</li> <li>CELL-MIMO isolation is the isolation between elements grouped for 4X4 MIMO for one modem.</li> <li>CELL-Adjacent isolation is the isolation between adjacent elements for separate modems.</li> <li>Parsec is currently phasing out inventory with LTE on our Cellular cables (now labeled CELL). For cables labeled LTE, please refer Port "CELL" in the data sheets and installation instructions.</li> </ul>			

## Part Number Key

Part number example of a 12:1 Bulldog antenna: PRO12BD8L4W15

Description	Abbreviation	Part Number
All PRO Series	PRO	PRO
Number of Antennas in Housing/Configuration	12:1	PRO12
Antenna Abbreviation for Bulldog	GP	PRO12BD
Number of CELL Elements	#L	PRO12BD8L
Number of Wi-Fi Elements	#W	PRO12BD8L4W
Cable Length Measured in Feet: 01=1', 15=15'	01, 07, 15	PRO12BD8L4W15
If SMA Connector, Simply Leave Blank		PRO12BD8L4W15
Custom connectors and cable kits are available. Please contact us for more information		

## Ordering

### Standard Antennas

<i><b>Config.</b></i>	<i><b>Part Number</b></i>	<i><b>Description</b></i>
<b>12:1</b>	PRO12BD8L4W02	8 Cellular, 4 Wi-Fi, 2 ft Cable

### Non-Standard Antennas

<i><b>Config.</b></i>	<i><b>Part Number</b></i>	<i><b>Description</b></i>
<b>4:1</b>	PRO4BD4L02	4 Cellular, 2 ft Cable
	PRO4BD4L15	4 Cellular, 15 ft Cable
<b>8:1</b>	PRO8BD4L4W02	4 Cellular, 4 Wi-Fi, 2 ft Cable
	PRO8BD4L4W15	4 Cellular, 4 Wi-Fi, 15 ft Cable
	PRO8BD8L02	8 Cellular, 2 ft Cable
	PRO8BD8L15	8 Cellular, 15 ft Cable
<b>12:1</b>	PRO12BD8L4W15	8 Cellular, 4 Wi-Fi, 15 ft Cable
SMA connectors have a max torque of 3-5 inch lbs.		

## Additional Hardware Accessories

<i><b>Accessory</b></i>	<i><b>Part Number</b></i>
Lightning Arrestor - SMA(F) to SMA(F)	PTA0476
Lightning Arrestor - N(F) to N(M)	PTA0736
SMA Wrench, Key Chain	PTA0194
Service: Cable Sleeving (Priced Per Ft)	Cable Sleeving



**Parsec Antennas**  
**972-804-4600**  
**support@parsec-t.com**