

FURUNO



FAQ

FREQUENTLY
ASKED
QUESTIONS

DFF1UHD+ Network Fish Finder

DFF1UHD+ FAQ



Overview

The DFF1UHD+ is a 1kw multi-channel network Fish Finder designed for integration with NavNet TZtouchXL MFDs.

The DFF1UHD+ combines traditional CW, CHIRP, and CHIRP Side-Scan in a single compact unit, with up to 1kW TruEcho™ CHIRP or CW Fish Finder technology and 230kHz or 455kHz CHIRP Side-Scan.

The DFF1UHD+ replaces the BBDS1 and DFF1-UHD Fish Finders

DFF1UHD+ Modes: ACCU-FISH™*, A-Scope, Manual Gain, Auto Gain (Fishing/Cruising), Bottom Discrimination*, TruEcho CHIRP™ *Compatible transducer required.



Connections

Q1. DFF1UHD+ Connections

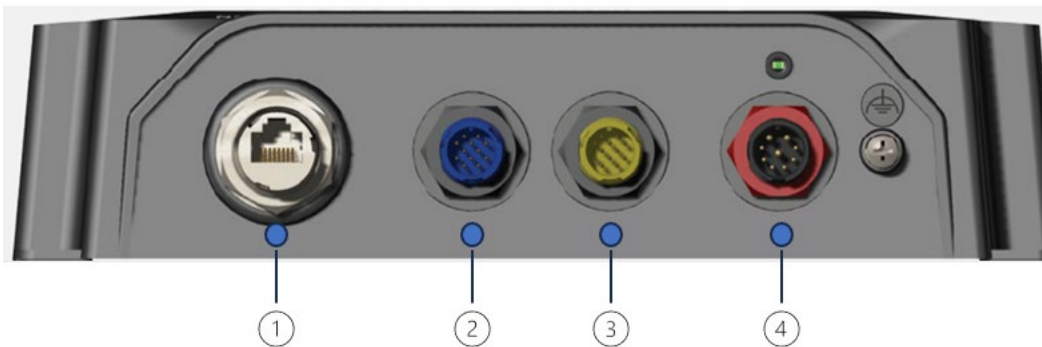
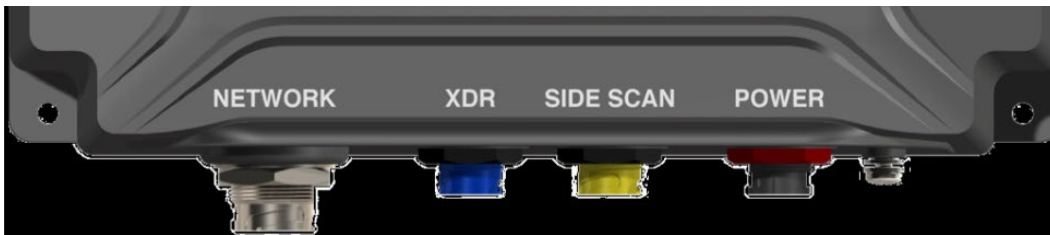

- 1 Waterproof RJ45**
- 2 12-pin (Blue) CW/CHIRP**
- 3 12-pin (Yellow) CHIRP Side-Scan**
- 4 9-pin (Red) Power and KP In/Out**

Q2. Inputs/outputs available on the Power cable

The Power cable has connections for Power and Key Pulse In/out.

Red	: PWR_IN+
Black	: PWR_IN-
Blue	: EXT_KP_IN_H
White	: EXT_KP_IN_C
Green	: EXT_KP_OUT_H
Yellow	: EXT_KP_OUT_C

NOTE :
Only connect to EXT_KP
when necessary.

Q3.

What comes standard in the box?



Q4.

How does the DFF1UHD+ compare to the BBDS1 and DFF1-UHD?

Model	DFF1UHD+	BBDS1	DFF1-UHD
Fish Finder Frequency	CW: 50/200khz CHIRP 40-225khz	50 & 200khz	50±20 & 200±25khz
Side Scan Frequency	230/455khz	NA	NA
Output Power	300/600/1kw	600/1kw	1kw
Accu-Fish	Yes *	Yes *	Yes *
Bottom Disc	Yes **	Yes **	Yes **
Max Depth	4000ft	2500ft	4000ft
Waterproof	IPX6	IP20	IP22
Compatibility	TZtouchXL	NavNet1, VX2, 3D, TZtouch, TZtouch2/3/XL	NavNet3D, TZtouch, TZtouch2/3/XL

***With Compatible Accu-Fish Transducer**

****With Compatible Bottom Discrimination Transducer**

Compatibility

Q1. What Furuno MFDs is the DFF1UHD+ compatible with?

The DFF1UHD+ is currently compatible with TZtouchXL MFDs. It is planned to be compatible with TZtouch3 and TZT2BB with future software releases for those products. It is not compatible with NavNet1, NavNet VX2, NavNet 3D, TZtouch, nor TZtouch2 MFDs, the TZTL12F and TZTL15F.

Q2. Is the DFF1UHD+ compatible with Nobeltec TZ software?

The DFF1UHD+ is planned to be compatible with a future software release for TZ Pro.

Q3. I have a mixed system that includes TZtouchXL and TXtouch3 and or a TZT2BB. Can I still add a DFF1UHD+ to my system?

Yes. However, only TZtouchXL MFDs are currently compatible with the DFF1UHD+ for control and display of Fish Finder echoes. You will not be able to control nor view the Fish Finder returns on a TZT2BB or TZtouch3 MFD until updated software is released for those products.

Q4. How many Fish Finders can I have in a NavNet TZTXL network?

A maximum of two active/selected Fish Finder sources, one CHIRP Side Scan, and one DFF3D Multi-beam Sonar are allowed on a NavNet network. The CHIRP Side Scan and the DFF3D multibeam Sonar are not counted as Fish Finders.

Note: You can have more than two Fish Finders on the network, but only two can be active at any time.

Transducers

Q1. What possible transducer combinations are available with the DFF1UHD+

Without Side-Scan

- > Dual CHIRP is possible
- > One single CHIRP is possible
- > One CW is possible
- > One single Mid-CHIRP + one CW is possible
- > Dual CHIRP + CW is **NOT possible**

With Side-Scan





- > One single CHIRP + CHIRP Side-Scan is possible
- > One CW + CHIRP Side-Scan is possible
- > Dual CHIRP with Side-Scan is **NOT possible**
- > Two single-CHIRP + Side-Scan is **NOT possible**
- > Two single-CHIRP + CW + Side-Scan is **NOT possible**

Dual CHIRP Configuration

Dual CHIRP Transducer

Transducer Options:

B265LH-12P	PM265LH-12P
B275LHW-12P	PM275LHW-12P
B275MWHW-12P	TM275LHW-12P
CM275LHW-12P	TM275MWHW-12P

<p>B265LH-12P B275LHW-12P B275MWHW-12P</p> 	<p>CM275LHW-12P</p> 	<p>PM265LH-12P PM275LHW-12P</p> 	<p>TM275LHW-12P TM275MWHW-12P</p> 
--	---	--	---

Dual CHIRP using two single frequency CHIRP Transducers

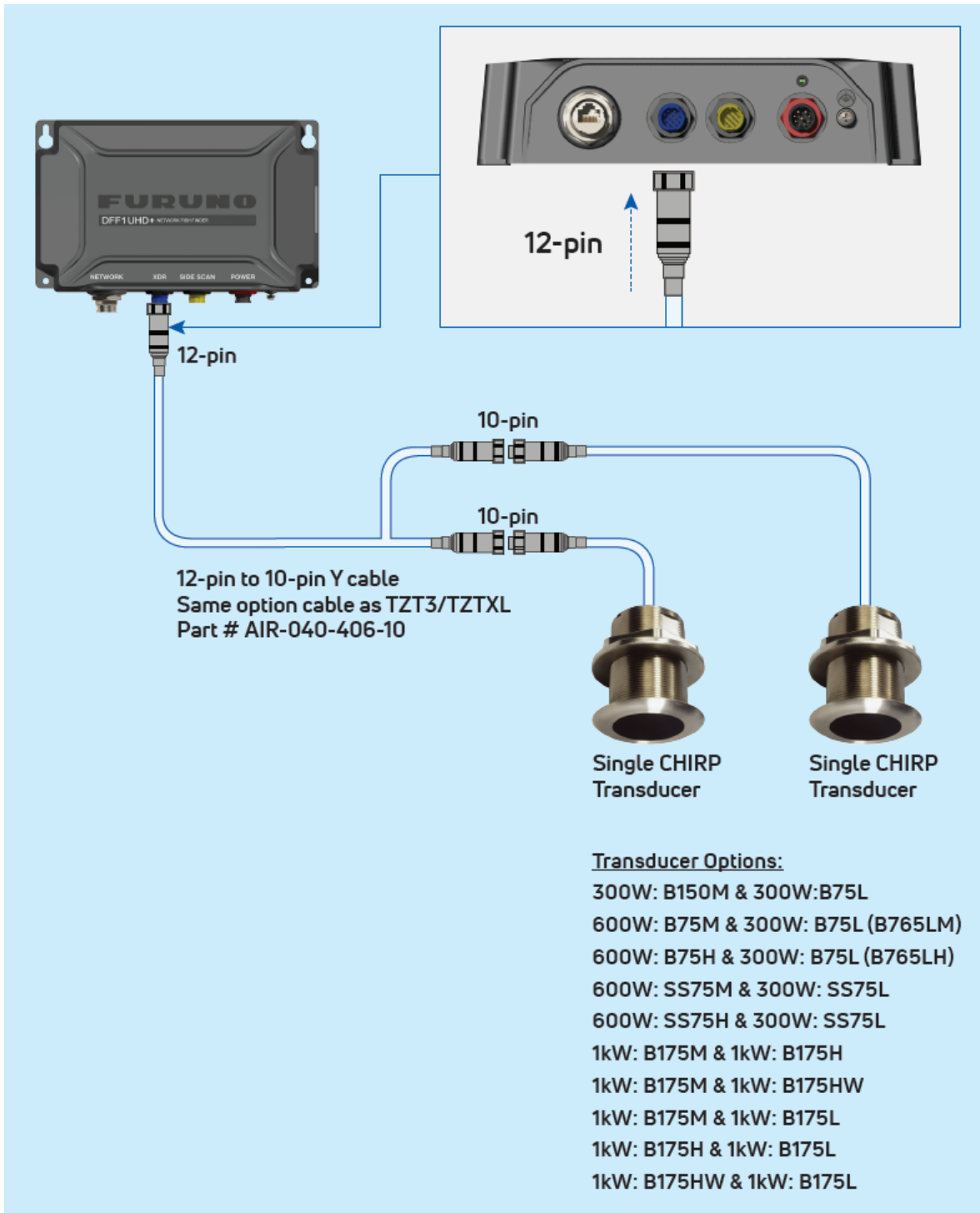

Notes:

- Optional Y-cable part # AIR-040-406-10 is required.

Single CHIRP or Conventional CW

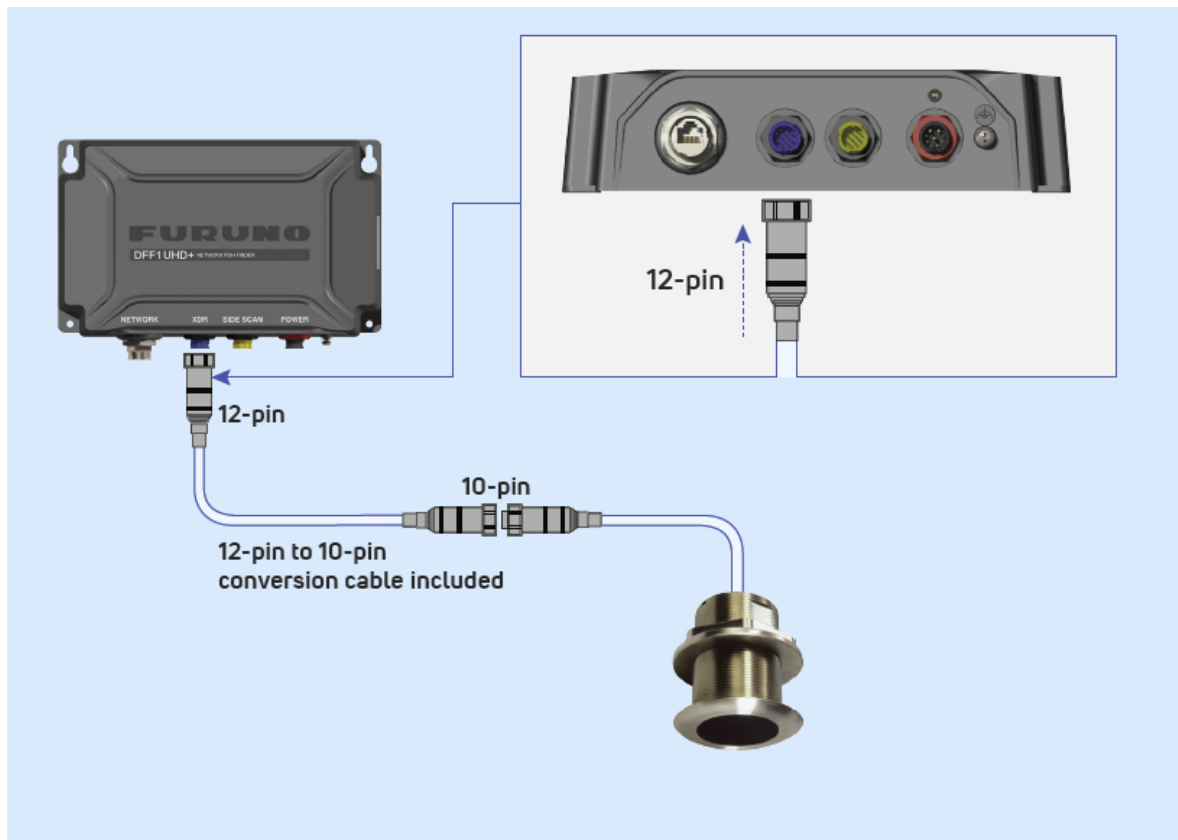

Single CHIRP

Transducer Options:

300W: B75L	1kW: B175M
300W: B150M	1kW: B175MW
300W: SS75L	1kW: B175HW
300W: B150M/TM150M	1kW: B285HW
600W: B75H	1kW: B285M
600W: B75HW	1kW: M285HW
600W: B75M	1kW: SS175H
600W: B785M	1kW: SS175L
600W: P75M	1kW: SS175M
600W: SS75H	1kW: SS175MW
600W: SS75M	1kW: SS175HW
600W: TM165HW	1kW: SS185HW
1kW: B175H	1kW: SS185M
1kW: B175L	1kW: SS185MW

CW

Transducer Options:

600W: 520-5PSD	1kW: CA50/200-1T
600W: 520-5MSD	1kW: TM260
600W: 520-PLD (P319)	1kW: CA50B-6/6B
600W: 525-5PWD	Generic 600W
600W: 525STID-MSD (B744V)	Generic 1kW
600W: 525STID-PWD (P66)	
600W: 525T-BSD (B45)	
600W: 525T-LTD/12 (B60-12)	
600W: 525T-LTD/20 (B60-20)	
600W: 525T-PWD (P66)	
600W: SS60-SLTD/12 (SS60-12)	
600W: SS60-SLTD/20 (SS60-20)	
1kW: CA50B-6/6B	
1kW: CA50B-6/6B & 200B-5S	
1kW: 526TID-HDD (B260)	

Notes:

- Must use included 12pin to 10pin adapter cable.

CHIRP Side-Scan

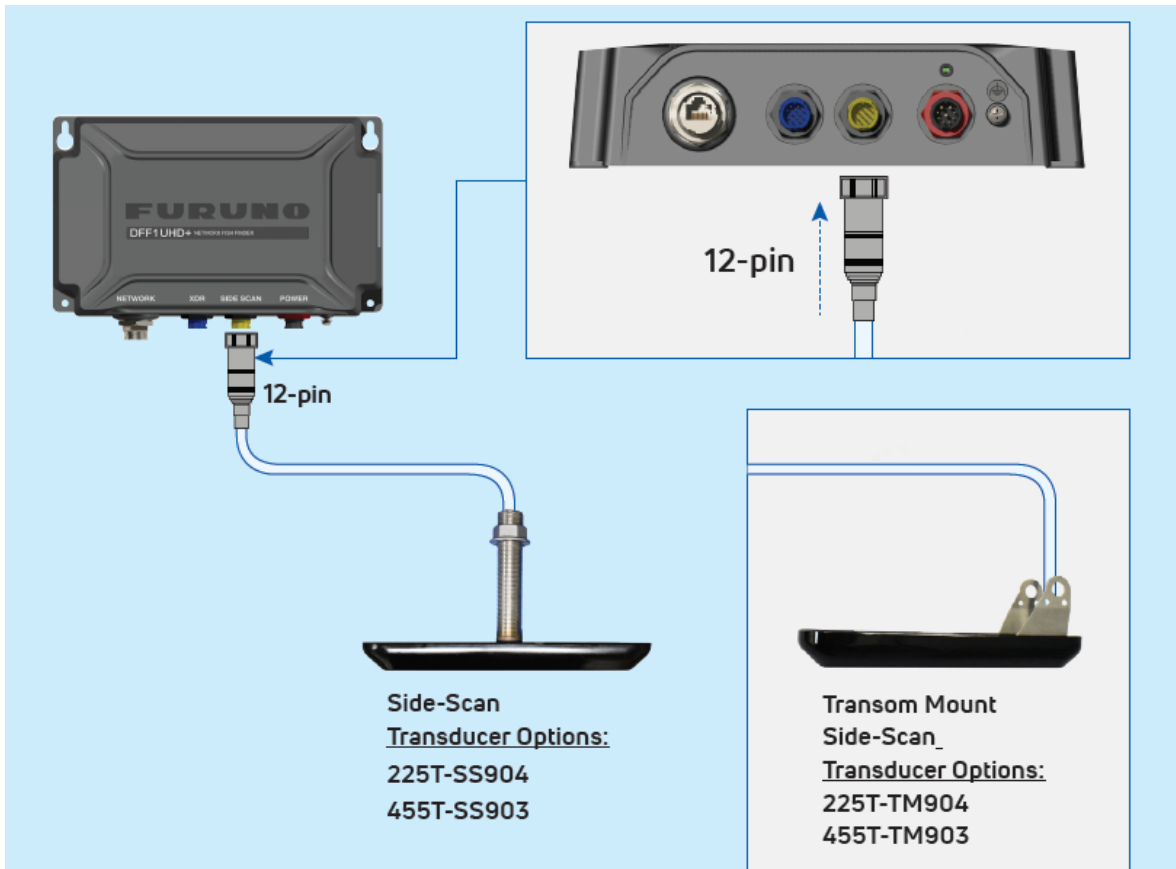

Pair Transducers:

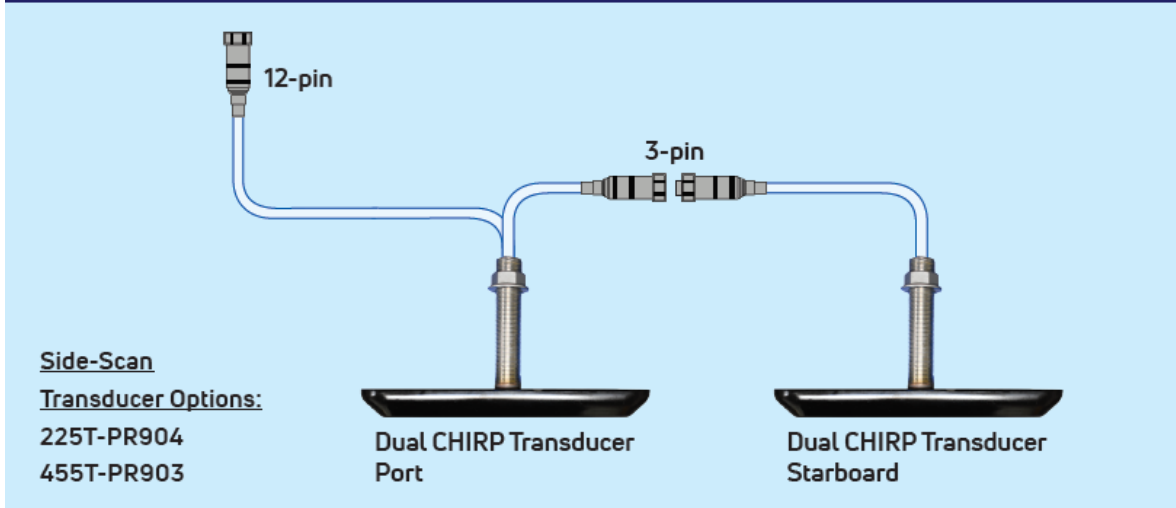

Notes:

- Pair Side-Scan transducers have 5 meters of cable between the two transducers.
- For Catamarans or installations requiring more than 4 meters of cable between the two sides, a 6m Side-Scan pair transducer extension cable is available, part # AIR-PSS-E6M.

Single CHIRP/CW + CHIRP Side-Scan

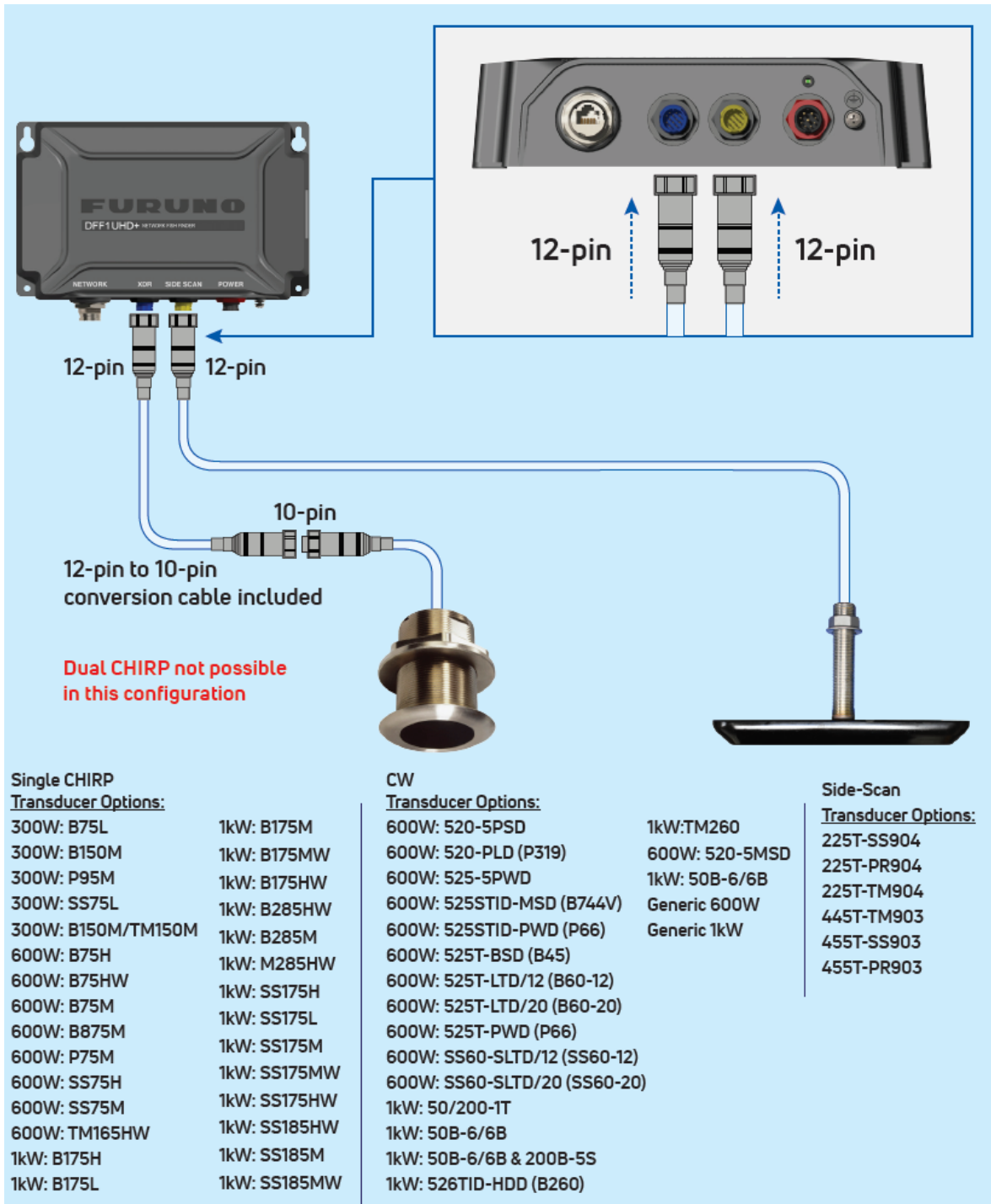

Notes:

- Must use included 12pin to 10pin adapter cable.
- Dual CHIRP and CHIRP Side-Scan is not possible using only one DFF1UHD+

Conventional CW and Single CHIRP

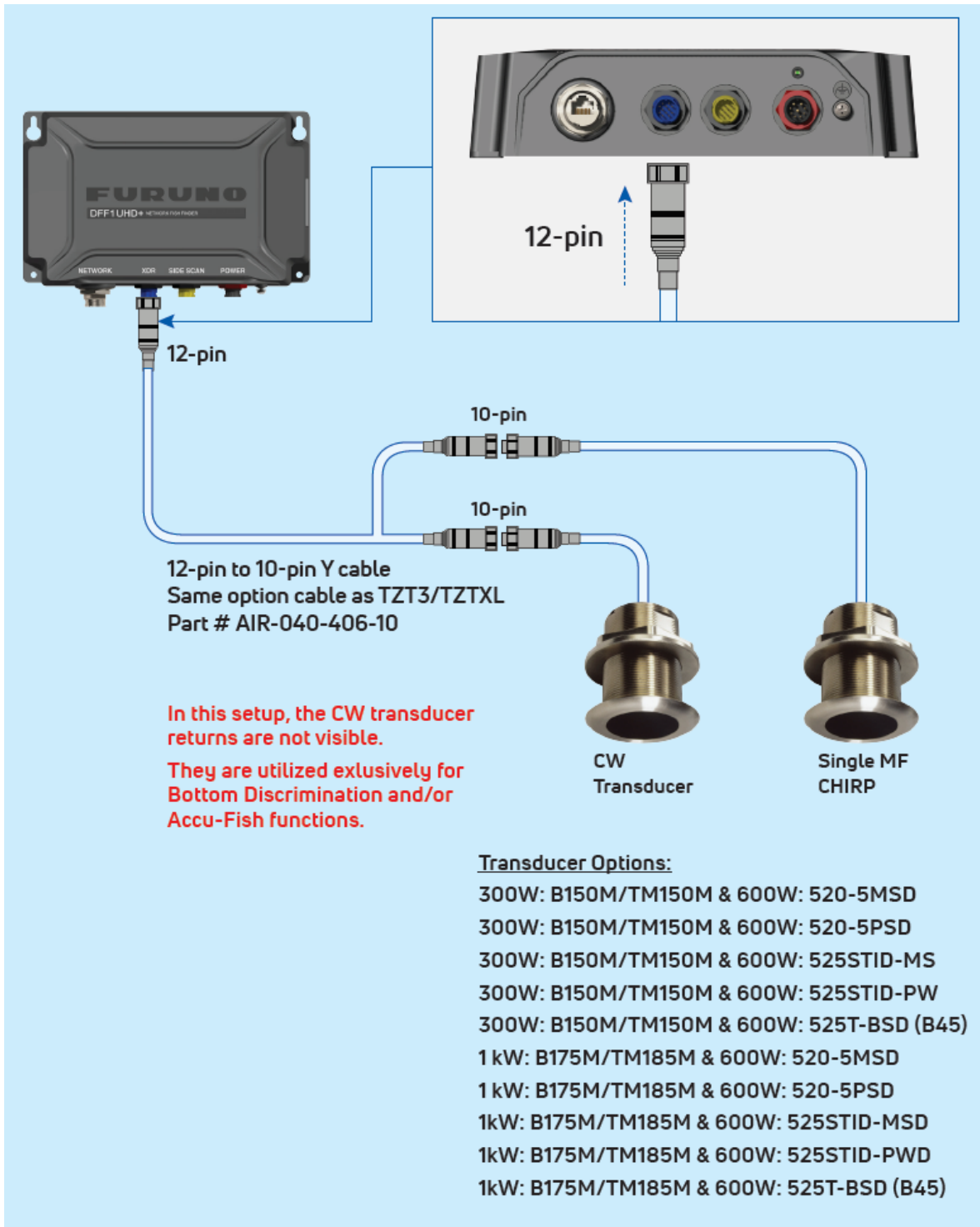

Notes:

- Optional Y-cable part # AIR-040-406-10 is required.
- CW returns are utilized for Bottom Discrimination and/or Accu-Fish functions. CW returns are not visible only the single frequency CHIRP returns are visible.

Q2. What transducer cable accessories are available for the DFF1UHD+

- 000-200-955-10 10-pin to 12-pin adapter cable (standard supply)
- 001-608-450-00 12-pin to 12-pin, 10m Transducer Extension Cable
- TZ3-12P-PGT 12-pin 1m Pigtail Cable Assembly
- AIR-040-406-10 12-pin to 2ea 10-pin Y-Cable
- AIR-PSS-E6M Side-Scan pair 6m transducer extension cable

Q3. What DFF1UHD+ CHIRP Side-Scan frequencies are available?

230Khz or 455khz. Transducer dependent. Available Side-Scan transducers are Transom, Thru-hull and paired versions of both 230 and 455khz.

230Khz Chirp Side Scan Transducer part numbers

- 225T-PR904 Paired Thru-Hull
- 225T-TM904 Transom Mount
- 225T-SS904 Thru-Hull

455Khz Chirp Side Scan Transducer part numbers

- 455T-PR903 Paired Thru-Hull
- 455T-TM903 Transom Mount
- 455T-SS903 Thru-Hull

Q4. Can the DFF1UHD+ use a B265LH for Bottom Discrimination?

No. Unlike the DFF1-UHD, which supports Bottom Discrimination using a B265LH CHIRP transducer, the DFF1UHD+ performs this function only with CW transducers.

Installation

Q1. What optional Ethernet cables are available for the DFF1UHD+?

Ethernet waterproof to waterproof (for use with HUB102)

- HUB-102-JMP .5m HUB102 to HUB102 connector cable
- 001-653-250-00 2m
- 001-653-260-00 5m
- 001-653-270-00 10m
- WRJ-ADP-05M .5m waterproof to field attachable RJ-45 connector.

Ethernet waterproof to non-waterproof

- 001-646-960-00 2m
- 001-646-980-00 5m
- 001-647-000-00 10m

Q2. Does the DFF1UHD+ support heave compensation?

Yes, with a compatible heave input to the NMEA 2000 bus. The Furuno SCX20 is recommended.

Troubleshooting

Q1. Power light status indication

LED State	Meaning
Lit Continuously	<ul style="list-style-type: none">• Standby state. If no signal is received via LAN for more than 10 minutes, the unit goes into standby.• Power on. (20 seconds during initialization)• IP address not set
Blinking every two seconds	Normal operation
Blinking every 0.4 seconds	Transducer settings on NavNet MFD not properly set.

End 9/10/2025